

INDUSTRIAL BUILDING FOR SALE

The property consists of two units, for commercial and storage use. They are portions of the basement of a residential four floors building. The property is located in Ladispoli Town, in Via Napoli, with direct access from this street. The entrance is allowed through a ramp for vehicles, connected to a small staircase. In order to get into the warehouse, another access is provided from the box. The commercial unit has a GLA of 139 m². It has a rectangular floor-plan and consists of a large area for offices directly illuminated by sunlight. The warehouse is a rectangular floor-plan with a GLA of 182 m².

Surface distribution

Site area Sqm	279
---------------	-----

Covered surface Sqm	279
---------------------	-----

Built area Sqm	279
----------------	-----

Warehouse	279
-----------	-----



Proposta immobiliare Celtic

Surface detail

Built area	Groundfloor	Total
Warehouse	279	279
TOTALE	279	279

Planimetry

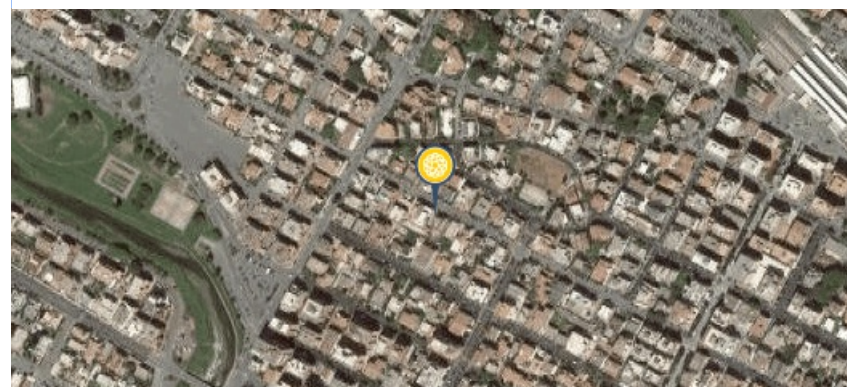
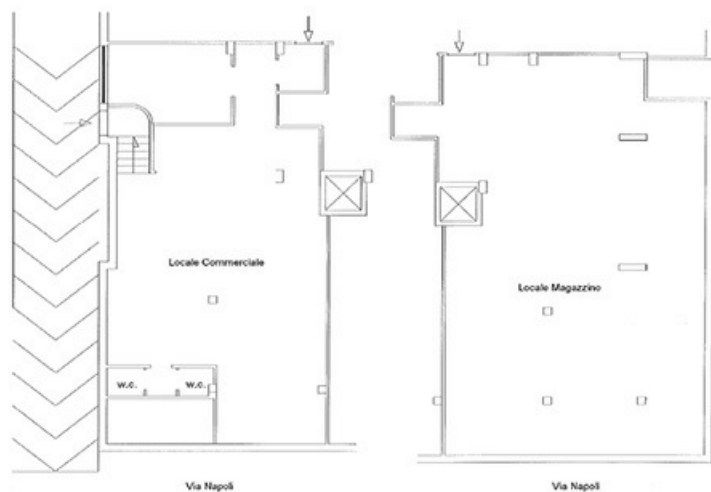

Near:

Autostrada A12 - Uscita Cerveteri-Ladispoli	4 km
Aeroporto Roma-Fiumicino	30 km
Roma	40 km

DISCLAIMER
Le informazioni contenute nel presente documento hanno finalità esclusivamente illustrative per quanto riguarda le caratteristiche generali del progetto. Il presente documento e le informazioni in esso contenute non rappresentano un'offerta o un contratto, né vanno interpretati come tali. In caso di discrepanza tra le informazioni contenute nel presente documento e le condizioni di vendita o di locazione, prevaleggiano le seconde.



Celtic AM srl
Via Brisa, 7
20123 Milan - Italy
info@celticitaly.it

T: +39 02 89095617
www.celtic-am.com

Celtic real estate proposal